

4. The device is on. Screw it back together.

5. Statuses, colours and behaviour of the diode (if the device is properly connected):

- Device is working correctly (power and memory) - single GREEN flash
- Device is working incorrectly (power and memory) - single RED flash
- Connecting to LoRaWAN - flashing BLUE
- LoRaWAN frame sent - single WHITE flash
- Confirmation from server after receiving the frame - single WHITE flash
- Frame failed to confirm within specified timeout - single RED flash
- LoRaWAN Disconnected - flashing BLUE
- Connecting to BLE - flashing BLUE

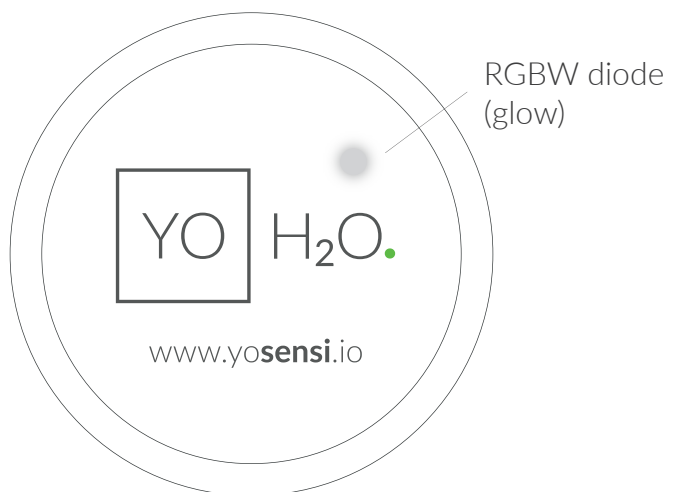

H₂O.

Quick Installation Guide

LoRa Alliance Member

1. Unscrew the device: remove 4 screws from the enclosure.
Gently disassemble the device so as not to bend the flood probes.

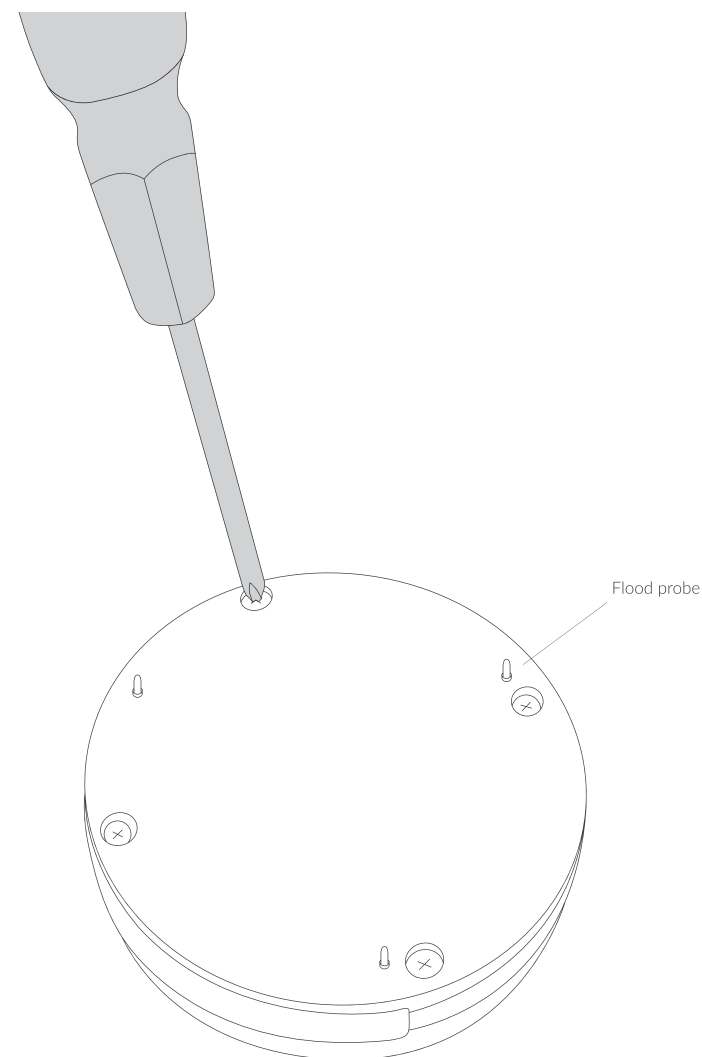

2. Place CR2450 3 V battery in the device according to the polarity.

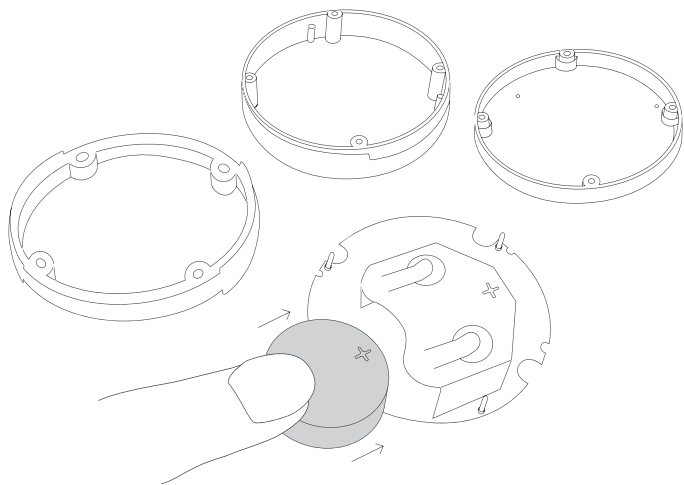

3. Assemble the device. The order of the elements is important:

- Place the seal (B) at the bottom of the enclosure (A)
- Then insert the PCB (C)
- Fit the top part of the enclosure (D)

! **Important!** Before assembling the device, be sure to check the tips in the following pictures.

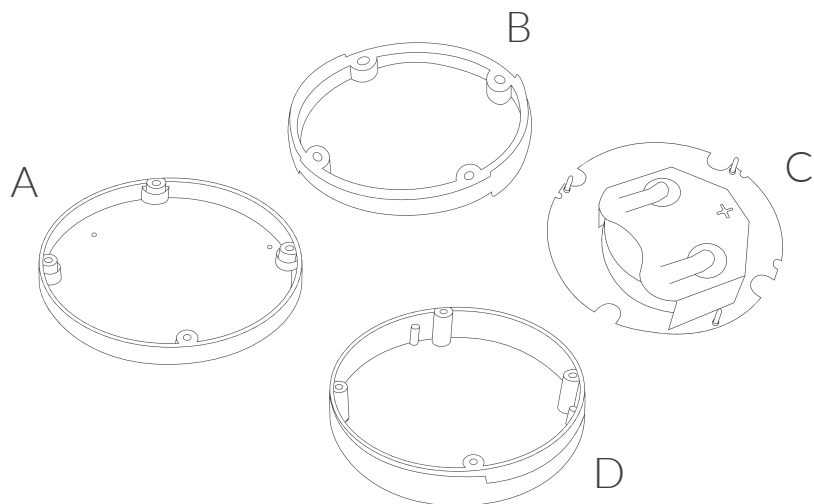

Tip 1: Adjust the flood probes as shown in the image below:

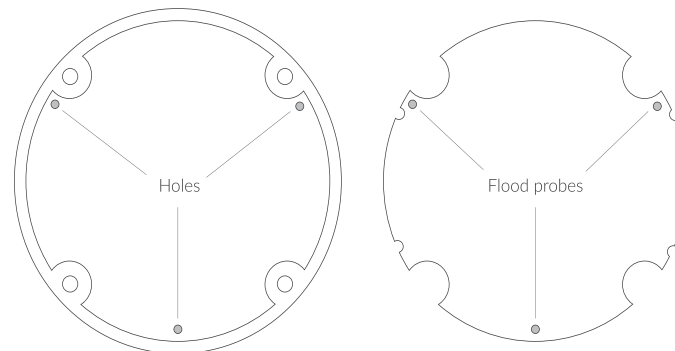

Tip 2: Match the PCB (marked component) to the top enclosure to the according to the diagram:

